



# FIRE HAZARD ZONE CONSTRUCTION REQUIREMENTS (CBC Ch. 7A / CRC Sec. 337 & DPMC)

Effective January 1, 2017

## BUILDING & SAFETY

33282 Golden Lantern, Suite 209  
Dana Point, CA 92629  
Tel: 949-248-3594

F002-REQ. VHFSZ

This sheet summarizes the construction requirements for structures located in any fire hazard severity zones, Very High Fire Hazard Severity Zone, and Ember Zones 1 and 2.

When an existing building undergoes alterations or additions, only those construction elements altered or added to the original structure are required to comply. Detached accessory structures classified as Group U occupancies and not exceeding 120 square feet in floor area when located 30 feet or more from a building are exempt from these requirements

Paints, coatings, stains or other surface treatments are not an approved method of fire protection. Fasteners in fire-retardant-treated wood shall be hot-dipped galvanized or stainless steel.

More information regarding fire hazard zone construction is available at: <http://osfm.fire.ca.gov>.

The walking surface of decks, porches, balconies, and stairs shall be ignition resistant construction, or meeting CBC 709A.

Guardrails shall be ignition resistant construction

The property shall be in compliance with vegetation management .



Ignition Resistant or Heavy timber 707A.9

Attic vents shall be ASTM E2886 listed, or protected with a corrosion-resistant and non-combustible material having 1/16" - 1/8" openings. CBC 706A

Skylights: Metal Framed and tempered glass

All new roofing shall be at least Class "A" per CBC 705A  
Roof Covering 705A.2  
Roof Valleys 705A.3  
Roof Gutters 705A.4

Protection at eaves shall comply with CBC 706A.3

Exterior windows, glazed doors, glazed openings within exterior doors (including garage doors), and structural glass veneer shall comply with one of the following per CBC 708A.2.1:

- Multiple pane with a minimum of one tempered pane.
- Glass block units.
- Have a fire-resistance rating of not less than 20 min. when tested according to NFPA 257.
- Approved per SFM Standard 12-7A-2.

Exterior doors shall comply with one of the following: (CBC 708A.3)

- Exterior cladding shall be a noncombustible or ignition resistant material..
- Constructed of solid core (1-3/8" thick with 1-1/4" min. panels.
- Have a fire-resistance rating of not less than 20 min. when tested according to NFPA 252
- Approved per SFM Standard 12-7A-1.

Exterior porch ceilings shall be ignition resistant construction or meeting CBC 707A.6

The underside of floor projections shall be ignition resistant construction CBC 707A.7

Exterior walls shall be non-combustible or ignition resistant construction, or meeting SFM STD 12-7A-1 CBC 707A.3

Wall architectural trim, Embellishments and fascia's, do not require protection.

### \*IGNITION RESISTANT CONSTRUCTION (704A)

Where ignition resistant construction is required, the exterior covering materials or assemblies shall be protected by any one of the following:

- Non-combustible material (stucco, metal).
- Ignition resistant material complying with SFM Standard 12-7A-5 (30 minute ASTM E84 or UL 723 test).
- Fire-retardant-treated wood identified for exterior use that complies with requirements of CBC Sec. 2303.2
- SFM approved Class "B" Fire-Retardant-treated wood shingles and shakes installed over solid sheathing.

### EMBER ZONE 1

New buildings and qualifying alterations/additions located within Ember Zone 1 for which an application for a building permit is submitted on or after the effective date of this ordinance shall comply only with the following CBC:

- 703A - Standards of Quality, as applicable
- 704A - Ignition Resistant Construction, as applicable
- 705A - Roofing and Skylight Requirements
- 706A - Vents
- 708A—Windows (Recommended, but not required)

### EMBER ZONE 2

New buildings and qualifying alterations/additions located within Ember Zone 2 for which an application for a building permit is submitted on comply only with the following sections of this chapter:

- 703A - Standards of Quality, as applicable
- 704A - Ignition Resistant Construction, as applicable
- 705A - Roofing and Skylight Requirements
- 706A - Vents
- 708A—Windows (Recommended, but not required)
- Decking
- Decks, porches, balconies and stairs shall comply with the requirements of Section 709A when:
  - A. The walking surface area of a single deck or balcony is greater than 100 square feet (increased to 120 square feet when connected to a stair); **and**
  - B. Located within 100 feet of fuel modification or open space containing unmanaged, non-irrigated vegetation.
- Decking within a Fuel Modification Zone: Decking located within any portion of a fuel modification zone shall be entirely non-combustible.
- Accessory Structures:
 

**Applicability.** The provision of this section shall apply to patio covers located closer than 100 feet from fuel modification or open space containing unmanaged, non-irrigated vegetation.

**Requirements.** The patio covers shall be constructed of noncombustible or ignition-resistant materials.

Exception: When the construction features meet all of the following:

- A. Columns: Minimum dimension of 4x4 (nominal dimension in inches)
- B. Horizontal beams: Minimum 4x6 (nominal dimension in inches)
- C. Top horizontal members: A minimum of 2-inch spacing is provided between the members.
- D. The ledger meets the ignition-resistant material definition as prescribed in CBC Section 702A.

### Very High Fire Hazard Severity Zone (VHFHSZ)

New Building and Qualifying alterations/additons shall comply with CBC7A, DPMC and requirements on this handout.

	Roof Patio	Shade Bar Cover	Deck
Columns:	6x8	6x6	8x8
Beams:	4x6	4x6	6x10
Joist:	4x	4x	4x
Ledger:	3x	3x	3x



**OPEN EAVE**

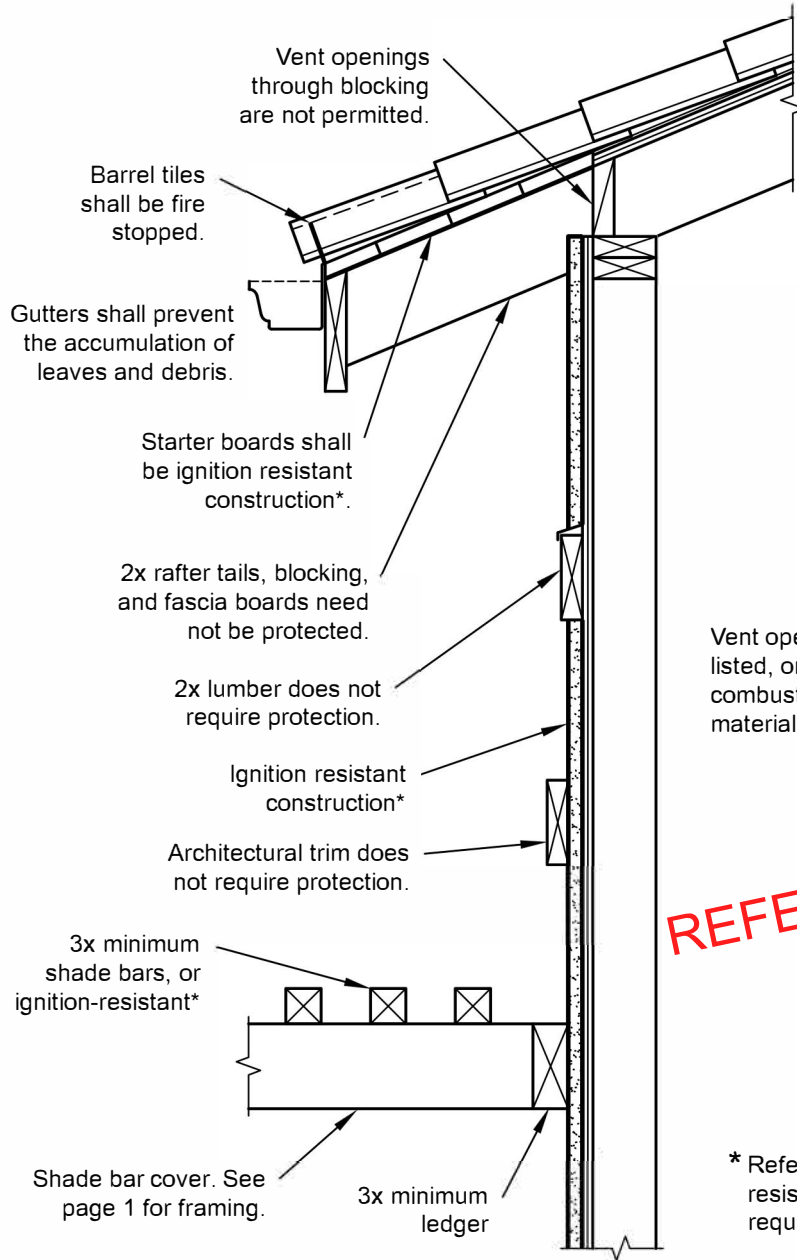

**ENCLOSED EAVE**

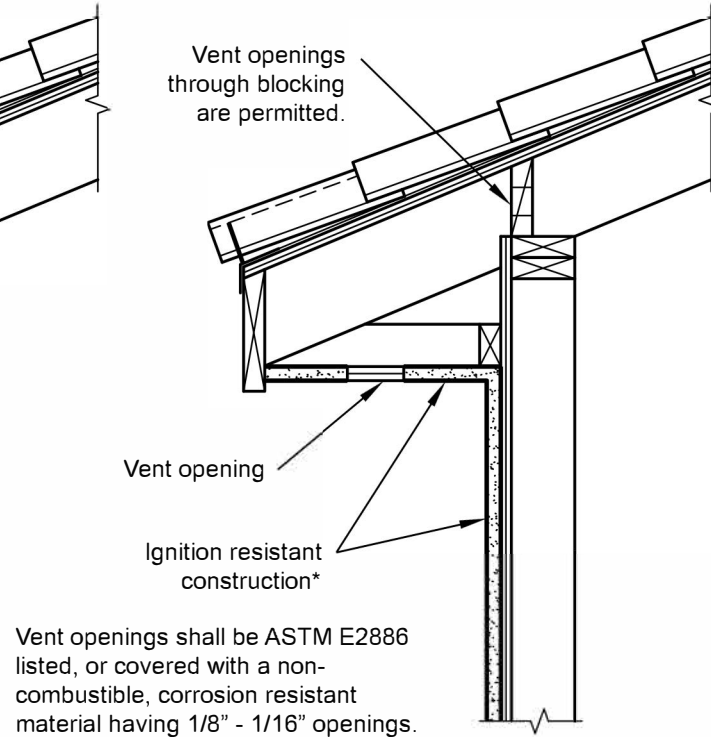

**GABLE END PROJECTION**

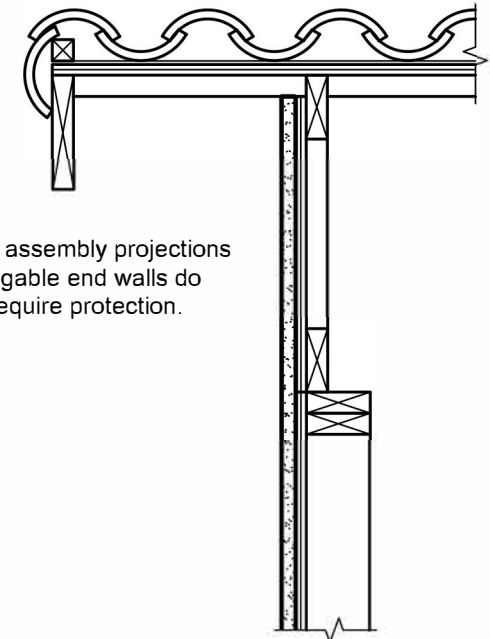

**ROOF VALLEY**

**REFERENCE ONLY**

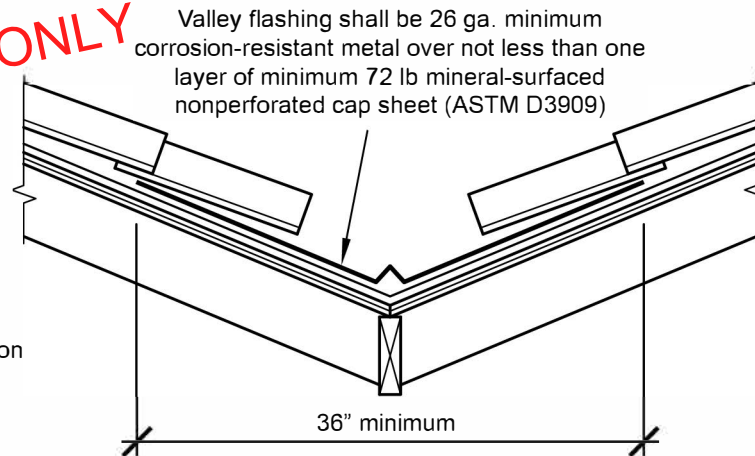

\* Refer to page 1 for ignition resistant construction requirements.